

BUSHFIRE ATTACK LEVEL (BAL) NOTE:
 CURRENT SITE HAS BEEN DETERMINED **BAL 12.5** AFTER THE BAL ASSESSMENT WAS CARRIED OUT IN ACCORDANCE WITH AS 3959 - 2009.
 BUILDINGS CLASSIFIED AS **BAL 12.5** SHALL BE CONSTRUCTED TO COMPLY WITH SECTIONS 3 & 5 OF AS 3959 - 2009.

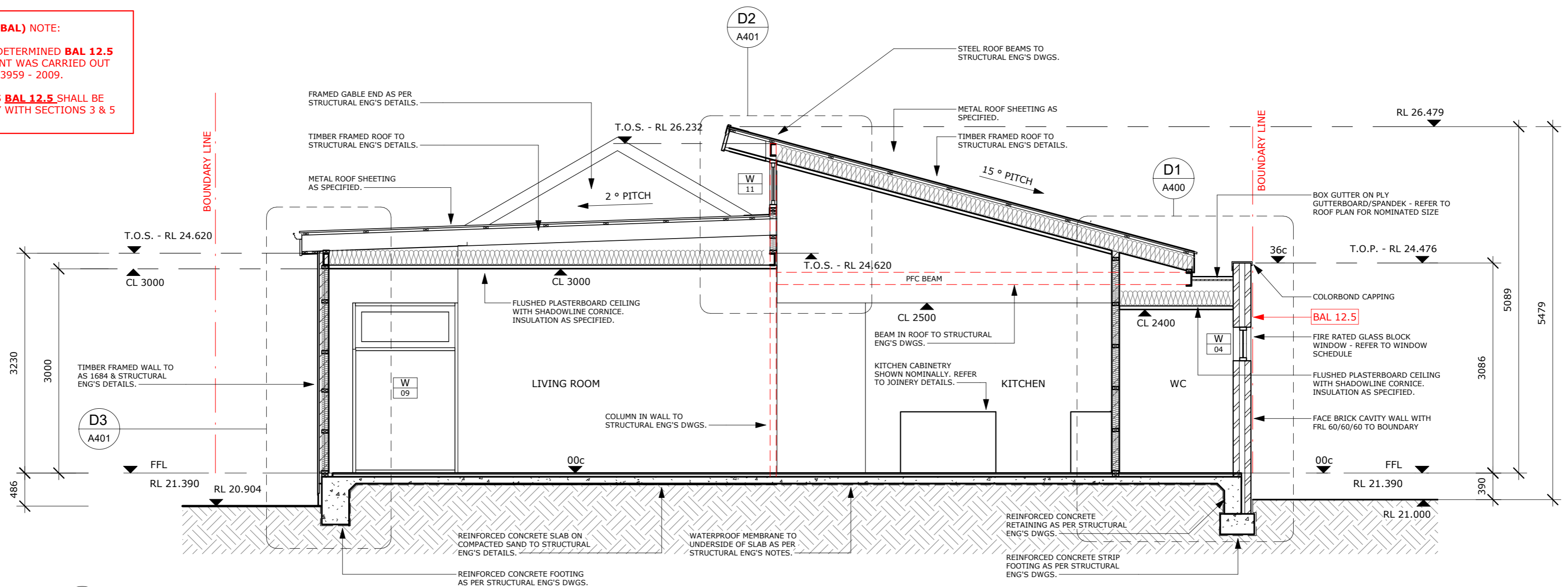

A SECTION A
 SCALE 1 : 50

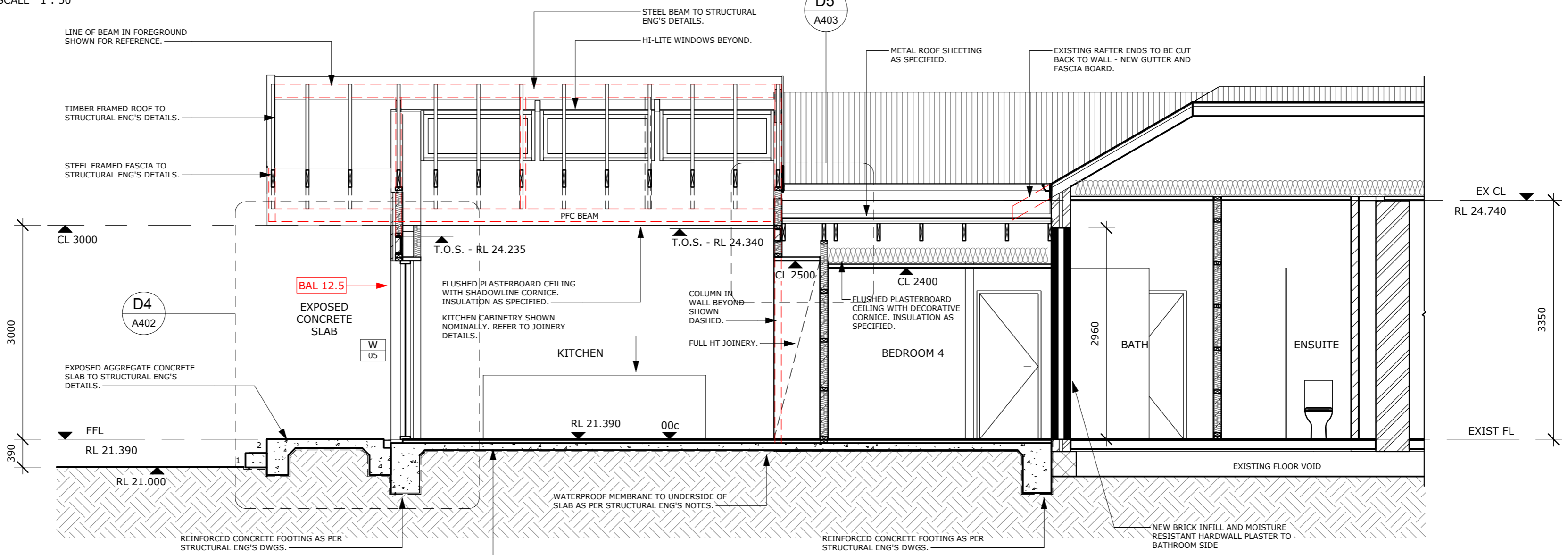

B SECTION B
 SCALE 1 : 50



Date	Rev	Description
26.08.17	A	ISSUED FOR BUILDING PERMIT

m 0451 195 657
 e sjhdrafting@gmail.com
 w www.sjhdrafting.com

PO BOX 70
 HILLARYS WA 6923
 abn 85 871 018 312

DO NOT SCALE THIS DRAWING
 ALL DIMENSIONS TO BE CHECKED ON SITE PRIOR TO CONSTRUCTION OR PRODUCTION.
 ALL DISCREPANCIES AND OMISSIONS ON SITE MUST BE REPORTED TO THE DESIGNER FOR THEIR COMMENTS OR APPROVAL PRIOR TO COMMENCING WORK.

PROJECT NUMBER: P17-014		© COPYRIGHT OF SJH DRAFTING	
SECTION - SHEET 1 of 3 127 ROSALIE STREET SHENTON PARK WA 6008 K ANDREWS & L MANNING			
DATE	DRAWN	CHECKED	SCALE
21.06.17	SJH	SJH	1 : 50
DWG No.		REV.	
A300		A	