

BUSHFIRE ATTACK LEVEL (BAL) NOTE:
 CURRENT SITE HAS BEEN DETERMINED **BAL 12.5** AFTER THE BAL ASSESSMENT WAS CARRIED OUT IN ACCORDANCE WITH AS 3959 - 2009.
 BUILDINGS CLASSIFIED AS **BAL 12.5** SHALL BE CONSTRUCTED TO COMPLY WITH SECTIONS 3 & 5 OF AS 3959 - 2009.

BAL 12.5

ALUMINIUM FRAMED CAVITY SLIDING DOORS AS SPECIFIED INSTALLED IN ACCORDANCE WITH MANUFACTURERS SPECIFICATION.

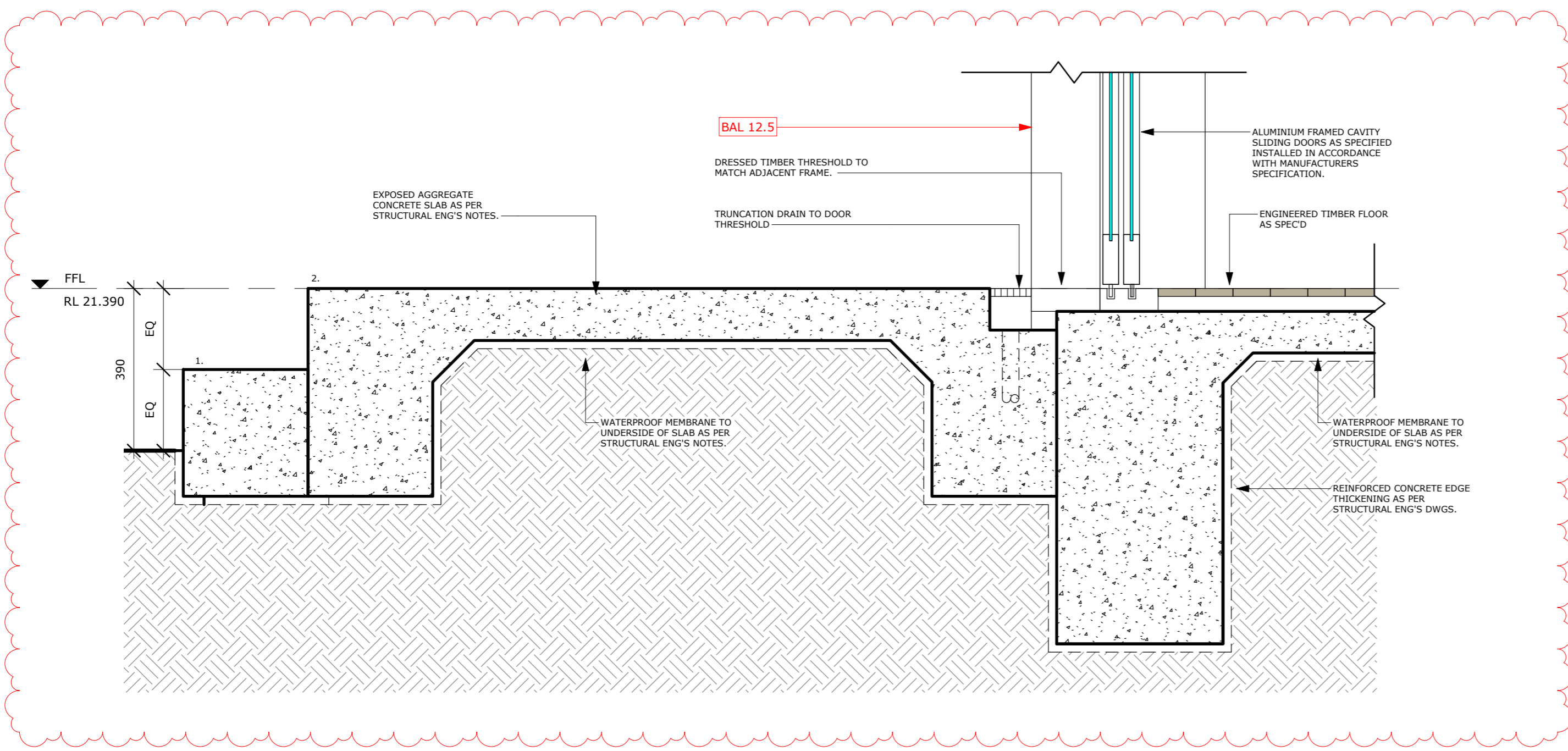

D4 CAVITY SLIDING DOOR THRESHOLD DETAIL
 SCALE 1 : 10

Date	Rev	Description
26.08.17	A	ISSUED FOR BUILDING PERMIT
20.11.17	B	REVISED BUILDING PERMIT INCORPORATING BAL

DO NOT SCALE THIS DRAWING
 ALL DIMENSIONS TO BE CHECKED ON SITE PRIOR TO CONSTRUCTION OR PRODUCTION.
 ALL DISCREPANCIES AND OMISSIONS ON SITE MUST BE REPORTED TO THE DESIGNER FOR THEIR COMMENTS OR APPROVAL PRIOR TO COMMENCING WORK.

JH DRAFTING
 m 0451 195 657 abn 85 871 018 312
 e sjhdrafting@gmail.com
 w www.sjhdrafting.com

PROJECT NUMBER: P17-014				© COPYRIGHT OF SJH DRAFTING	
DETAILS 127 ROSALIE STREET SHENTON PARK WA 6008 K ANDREWS & L MANNING					
DATE	DRAWN	CHECKED	SCALE	DWG No.	REV.
21.06.17	SJH	SJH	1 : 10	A402	B